



MINIMAAL EN MOOI
HOUTWERKE



New Countertop Measurement Guideline

minimaalenmooi.com



INTRODUCTION

Whether you're remodeling your kitchen, upgrading a bathroom vanity, or installing a new island, careful measurement is the foundation of your project's success.

Wooden countertops, with their natural elegance and warmth, require precise dimensions to align seamlessly with your space.

This guide provides a structured approach, complete with industry best practices, to ensure accuracy when measuring for countertops.





TOOLS YOU'LL NEED

Gather the following tools before starting:

- **Steel Measuring Tape (in mm):** A high-quality measuring tape for precise readings.
- **Pen and Graph Paper:** For sketching your layout and recording measurements accurately.
- **Calculator:** Useful for area calculations and conversions.
- **Level:** To check the flatness of your cabinets and walls.
- **Straight Edge or Ruler:** To confirm straight lines and wall edges.
- **Masking Tape (optional):** To mark critical points during the process.

PREPARING YOUR SPACE

- **Clear the Area:** Remove all items, such as appliances, decorations, or existing countertops, from the workspace.
- **Inspect the Site:** Check for irregularities in walls or cabinetry that might affect measurements, such as uneven surfaces or gaps.



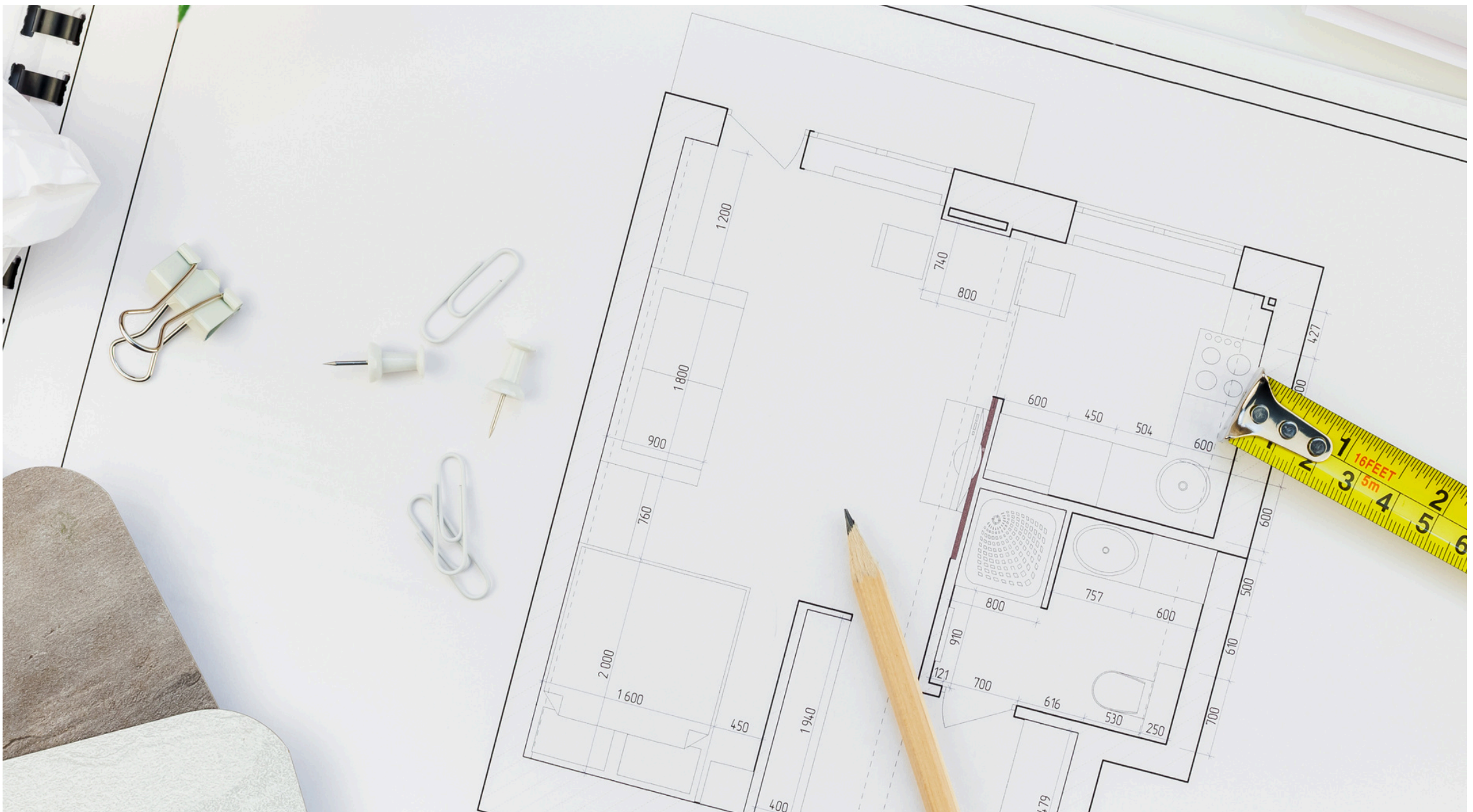

DRAWING A ROUGH SKETCH

Start by sketching a bird's-eye view of your kitchen or bathroom.

- Include key elements such as walls, cabinets, appliances, sinks, and any other fixtures.
- Label each section (e.g., "Section A," "Island," "Sink Area") for easier reference later.

USE THE BELOW SKETCH KEY TO STANDARDISE YOUR DRAWINGS AND TO HELP VISUALISE YOUR CABINETRY AND COUNTERTOPS

Key

Countertop Measurement → 

Cabinet Measurement → 

Backsplash → 

Cabinets → 

Countertop → 



MEASURING COUNTERTOP DIMENSIONS

- **Measure the Length:** Using your measuring tape, measure each section's length along the back edge, from one wall or edge to the other. Write down measurements in millimeters (e.g., 2450 mm).
- **Measure the Width (Depth):** Measure from the back wall to the front edge of the countertop. Standard countertop depths are approximately 600 mm to 650 mm, but always verify based on your specific needs.
- **Account for Overhangs:** Overhangs at the front of cabinets typically range from 30 mm to 40 mm. Include these in your width measurements.

STRAIGHT COUNTERTOP / ISLAND / VANITY TOP

Allow for overhangs on any exposed ends. If measuring cabinets, note any overhangs on exposed ends.

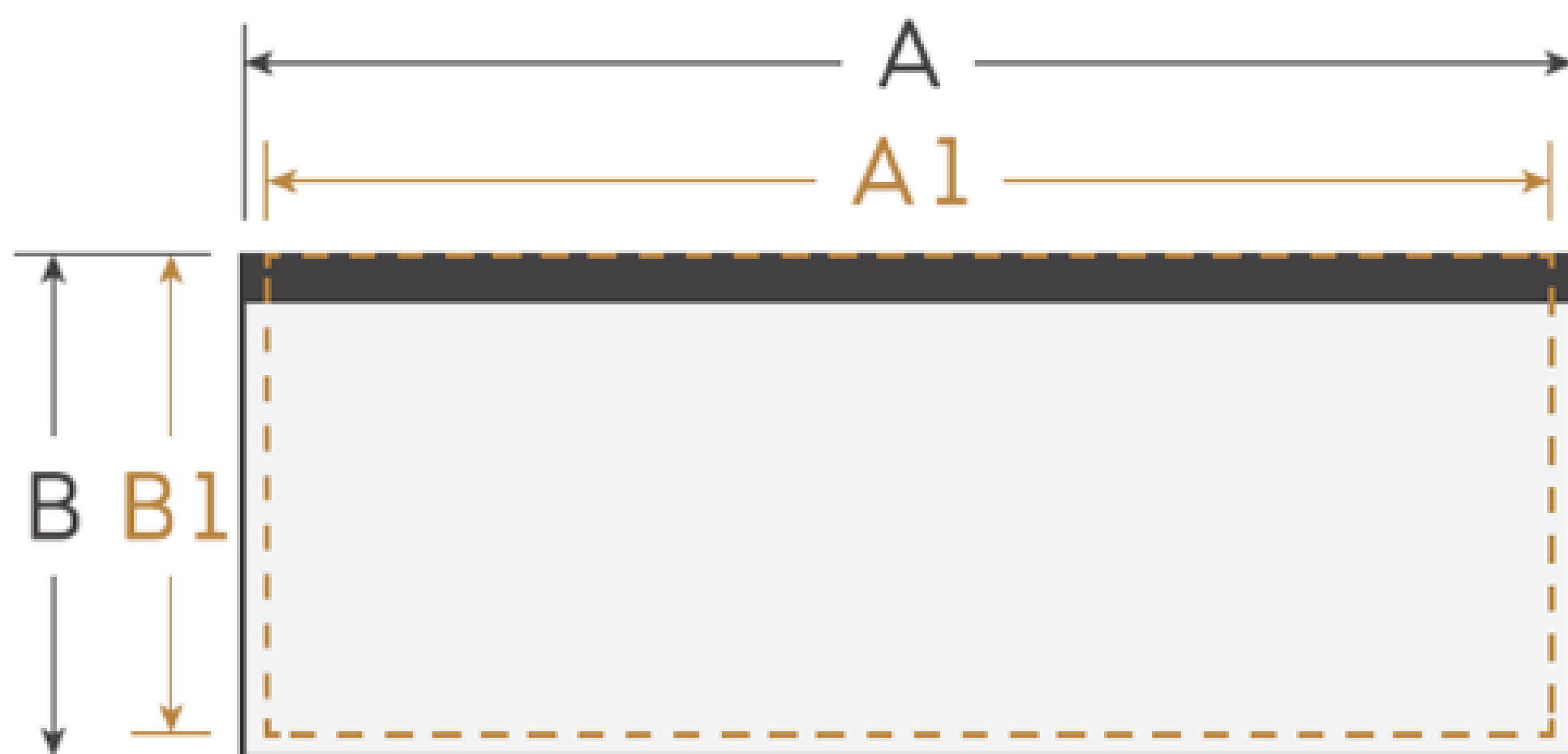

A typical measurement for a countertop like this would look like: $A \times B \times H$ or Length x Width x Height or Thickness, for example 1800x600x32mm for a typical countertop or 1800x1200x44mm for an island

Key

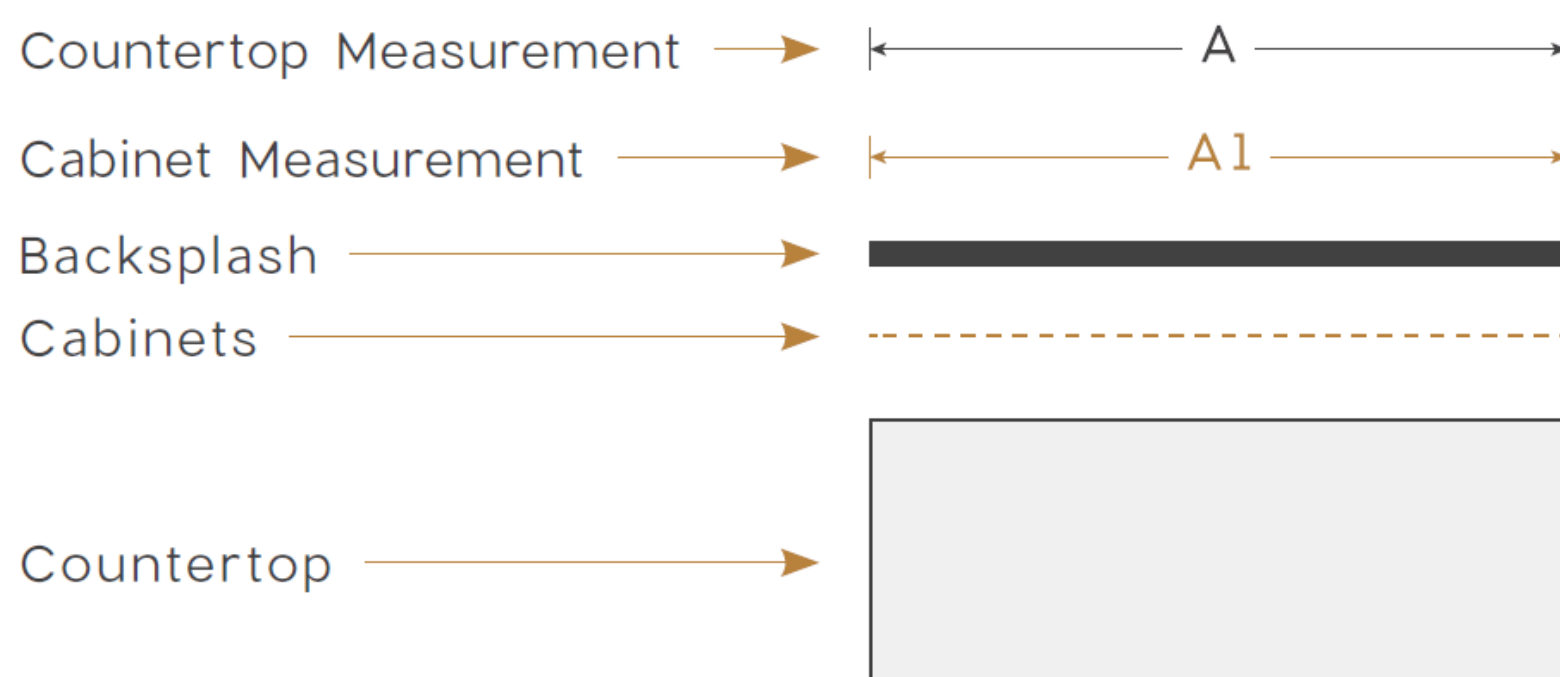

MEASURING COMPLEX LAYOUTS

- **L-Shaped or U-Shaped Countertops:** Divide these into rectangular sections. Measure each section separately, noting the lengths and widths in mm. Record any corner measurements to ensure proper fitting.
- **Islands and Peninsulas:** Measure all sides of islands and peninsulas, recording both length and width. For seating areas, overhangs should be 300 mm to 400 mm for adequate legroom.

CORNER COUNTERTOP SECTION

Whenever two pieces of countertop join together, a butt or miter seam will be necessary (butt joint, or a 45° miter join from the back corner to the inside corner).

If you are making dimension changes from existing countertops to new countertops, be sure to consider space needed to accommodate any extra length or width added.

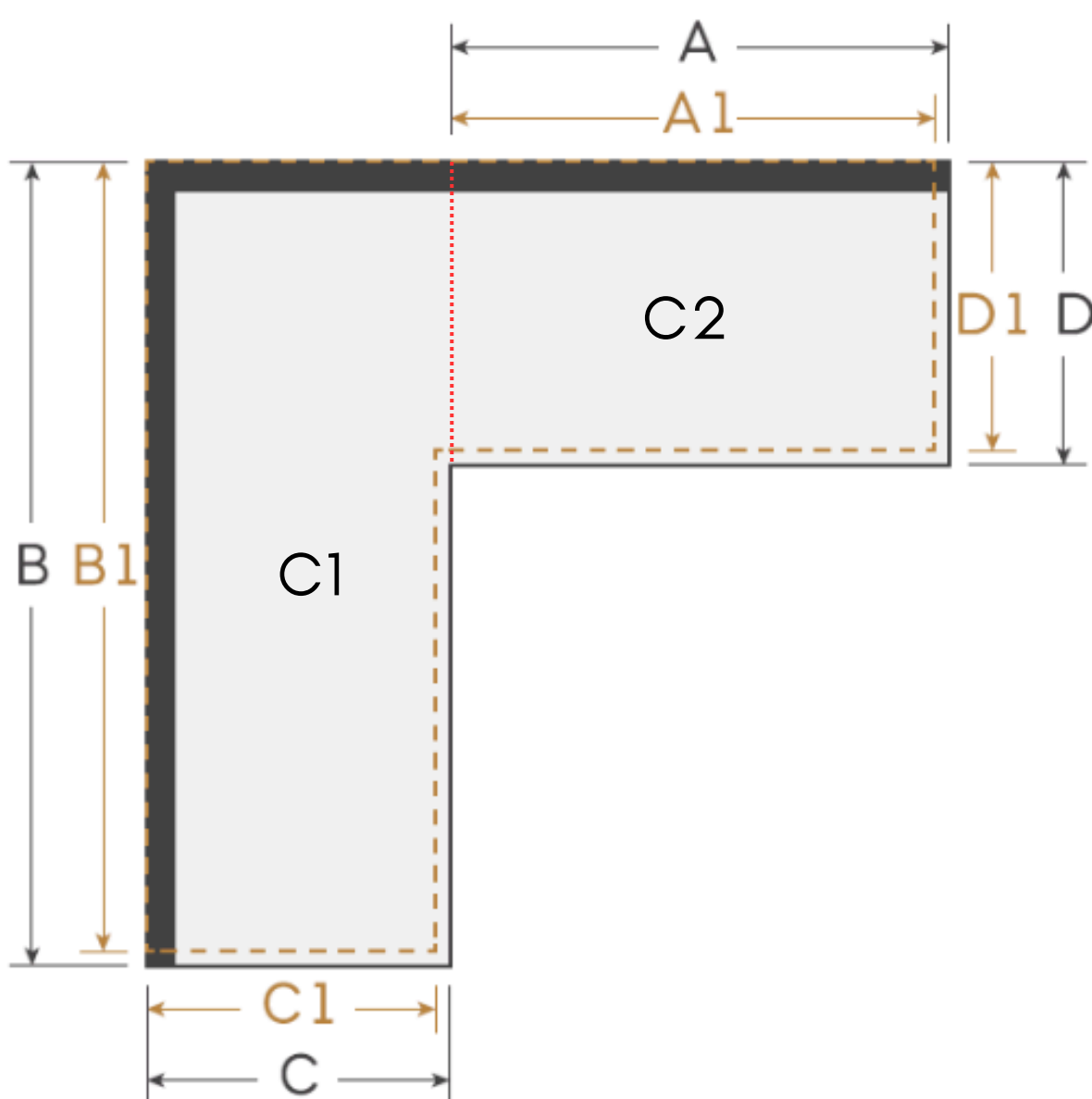

BUTT JOINT

This corner sketch indicates two countertops C1 and C2 whereby the two countertops are joined in a straight line at 90°

This is the most affordable joining option

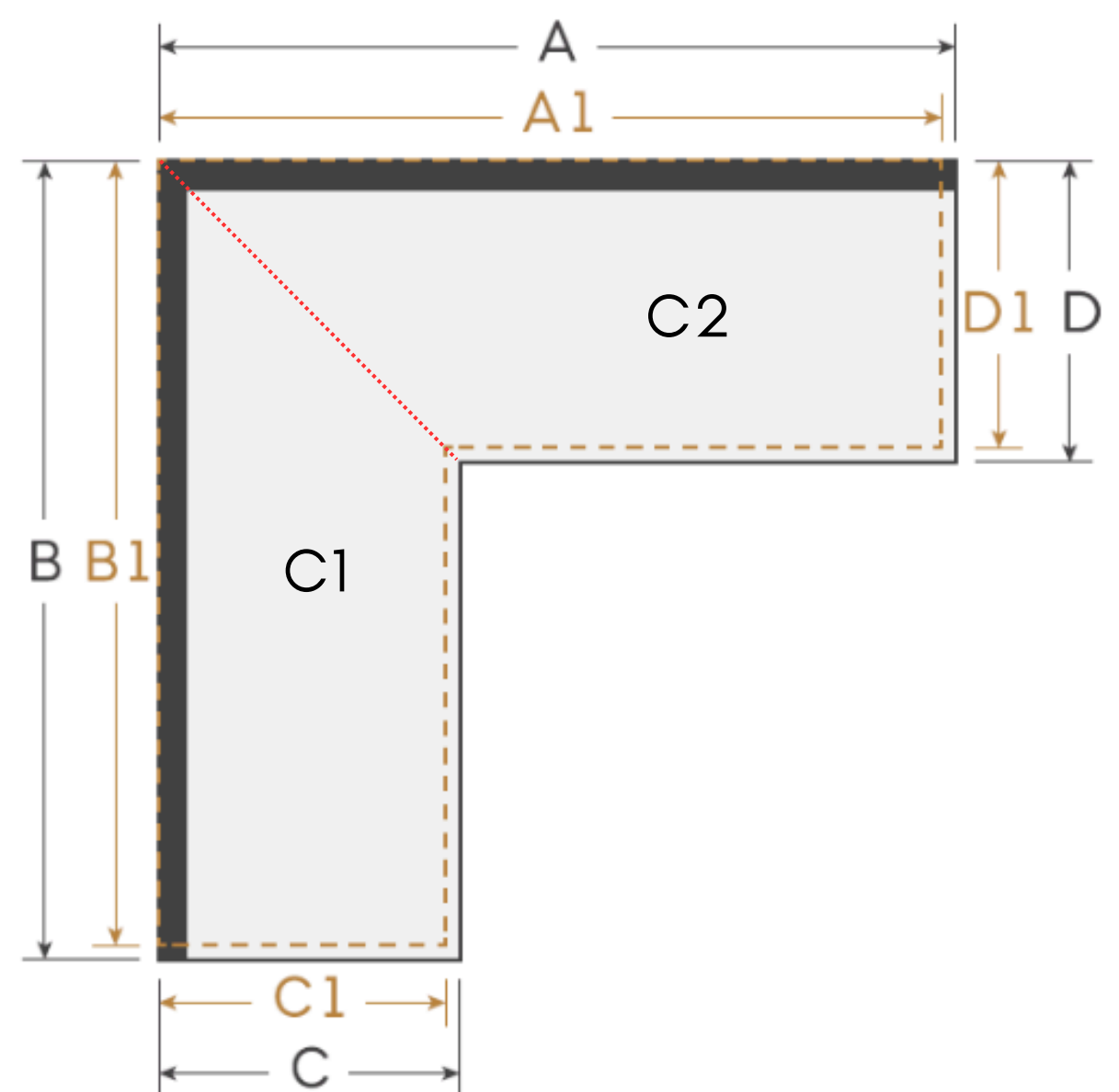

45° MITER JOINT

This corner sketch indicates two countertops C1 and C2 whereby the two countertops are joined in a straight line at 45° using a mitre joint

This is the more expensive joining option

MEASURING FOR SINKS AND APPLIANCES

- **Sink Cutouts:** Measure from the right-most edge of the countertop to the center of the sink plumbing. Record the width and depth of the required cutout, as well as the total size of the sink. Note the sink's brand and model if available.
- **Appliance Cutouts:** For cooktops, measure from the nearest countertop edge to the appliance's center and record the cutout dimensions in mm.

SINK CUTOUTS

Sink cutouts require the measurement from the right-most end of the piece containing the sink hole to the center of the plumbing or sink base (A2). Sink cutouts size is needed. Note the sku, brand, and model number of the sink you will be installing.

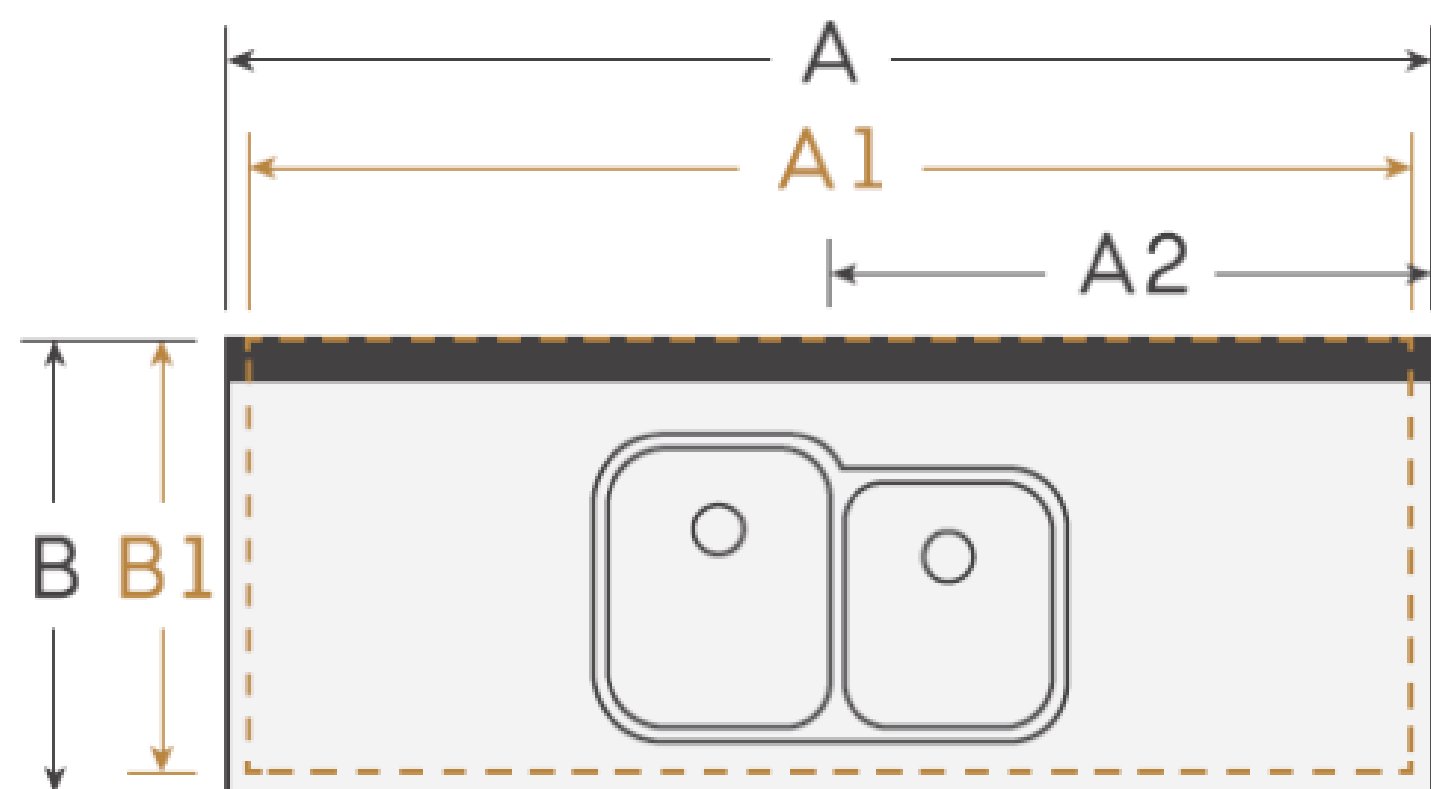

Handmade/hammered/butler sinks will require additional measurements before cutting, as each sink can vary slightly.

DROP-IN APPLIANCE CUTOUTS

Drop-in appliances require the measurement from the right-most end of the countertop to the center of the appliance (A2). Appliance cutouts size is needed. Note the sku, brand, and model number of the appliance you will be installing.

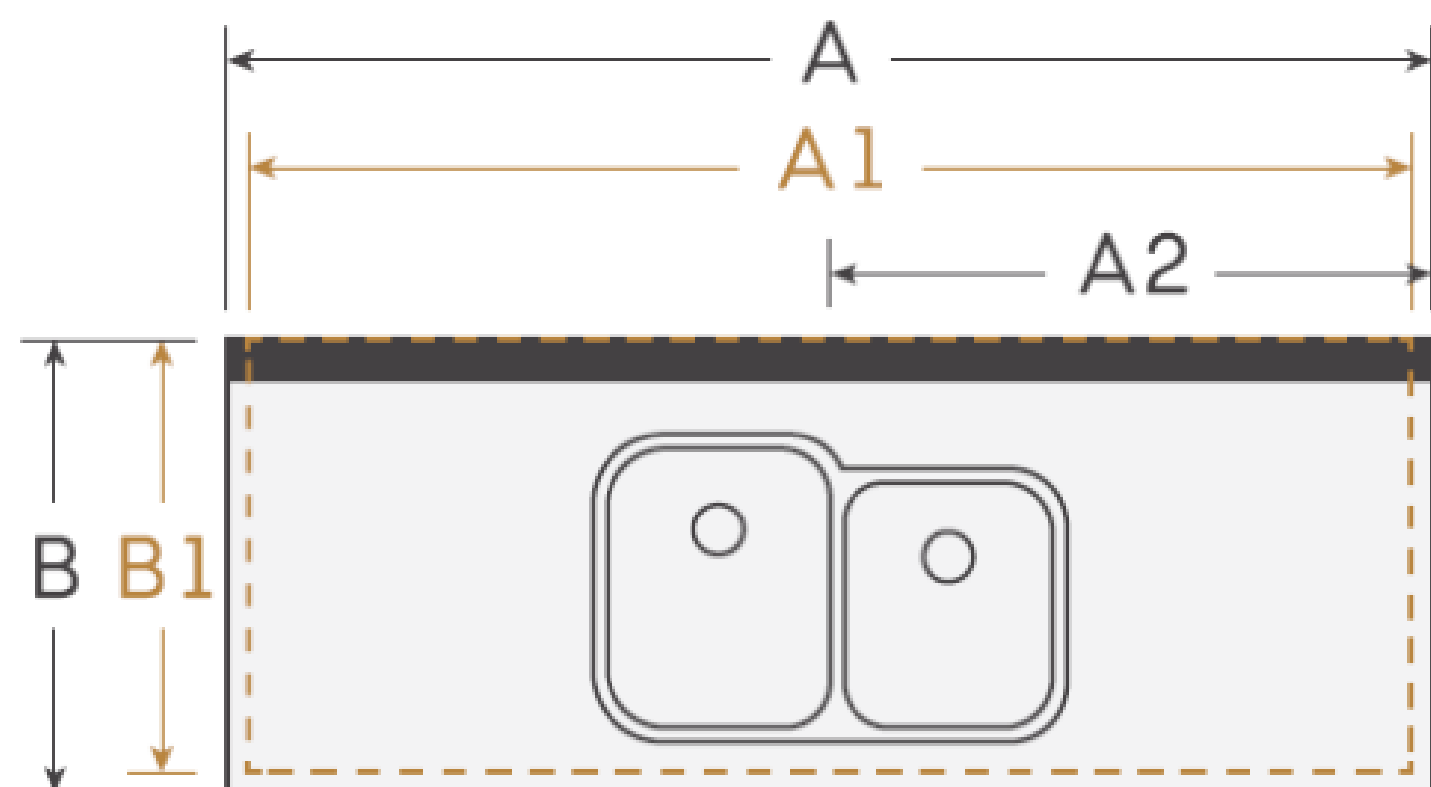



BEST PRACTICES FOR ACCURACY

- **Double-Check Measurements:** Always measure twice to confirm accuracy. Even a small error can create significant installation challenges.
- **Check for Square Corners:** Measure 1 meter along one wall, 1.5 meters along the adjacent wall, and the diagonal between these points. If the diagonal is 1.8 meters, your corner is square.
- **Account for Wall Irregularities:** If walls are uneven, measure the shortest and longest widths, and use the larger measurement to ensure sufficient material.

ADDITIONAL CONSIDERATIONS

- **Backsplash Measurements:** If including a backsplash, measure the height from the countertop surface to the desired endpoint (usually 100 mm to 150 mm or full height to under wall cabinetry) and the length along the wall.
- **Thickness Preferences:** Confirm the thickness of your wooden countertop (typically 32mm for kitchen counters and 44mm for Islands) to ensure it complements your cabinetry.
- **Expansion Gaps:** Wood expands and contracts with temperature and humidity. Leave a 5 mm expansion gap along walls.



NOTES & SKETCH AREA

How to Use This Section

- Use the provided graph paper to draw a scaled version of your countertop layout. **Each square represents 10 cm (or another chosen scale).**
- Also mark areas for sinks, appliances, and overhangs.
- Add notes alongside your sketches to record precise dimensions, preferences, and additional details, the more detailed the better.

EXAMPLE

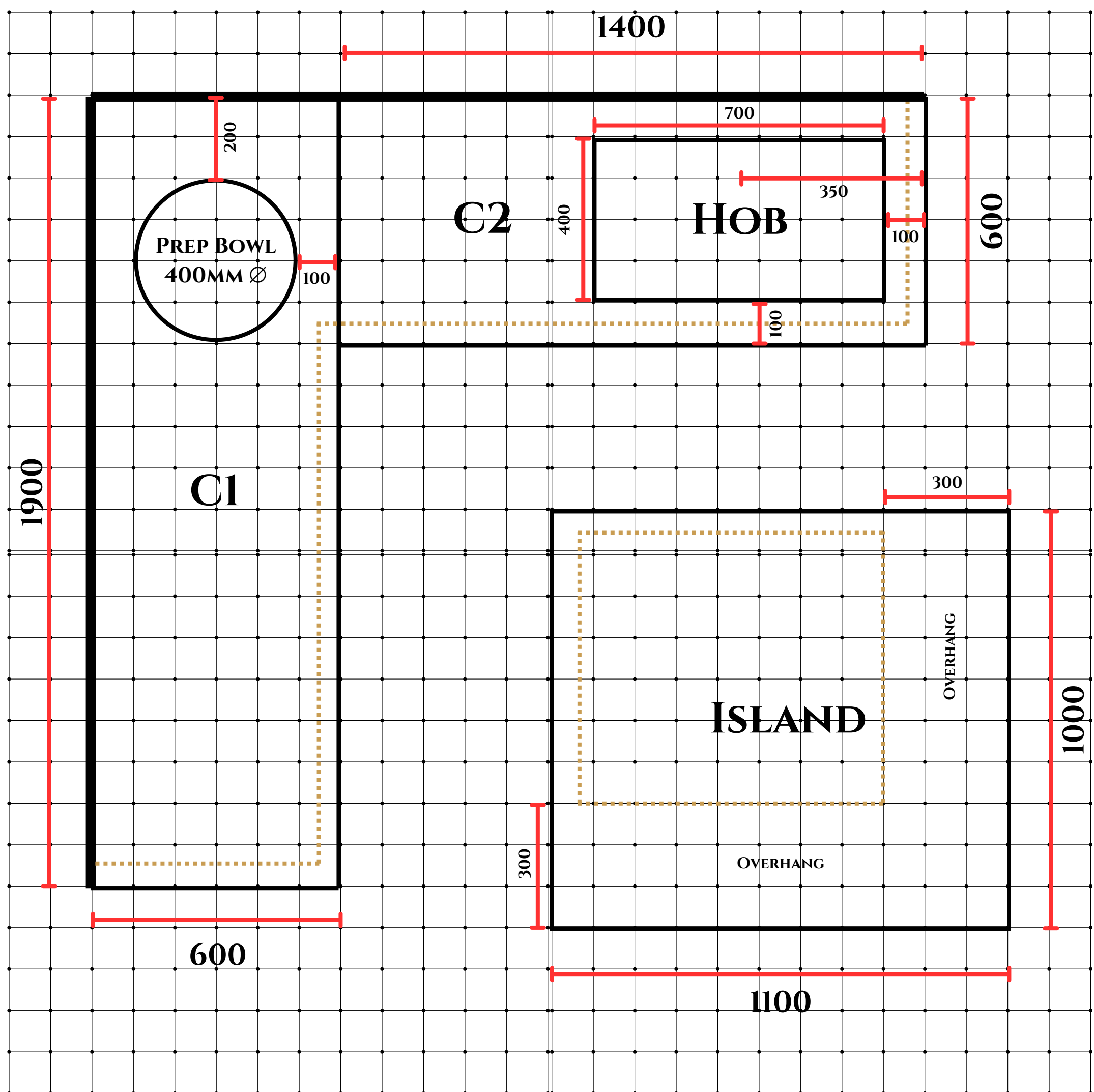

NOTES:

Countertop 1 Dimensions: 1900x600x32mm + 400mm \varnothing Prep Bowl cut out

Countertop 2 Dimensions: 1400x600x32mm + 700x400mm Hob cut out

Island Dimensions: 1100x1000x44mm (300mm overhangs which need reinforcement)



SKETCH AREA

ROOM: _____

DATE: ____/____/____

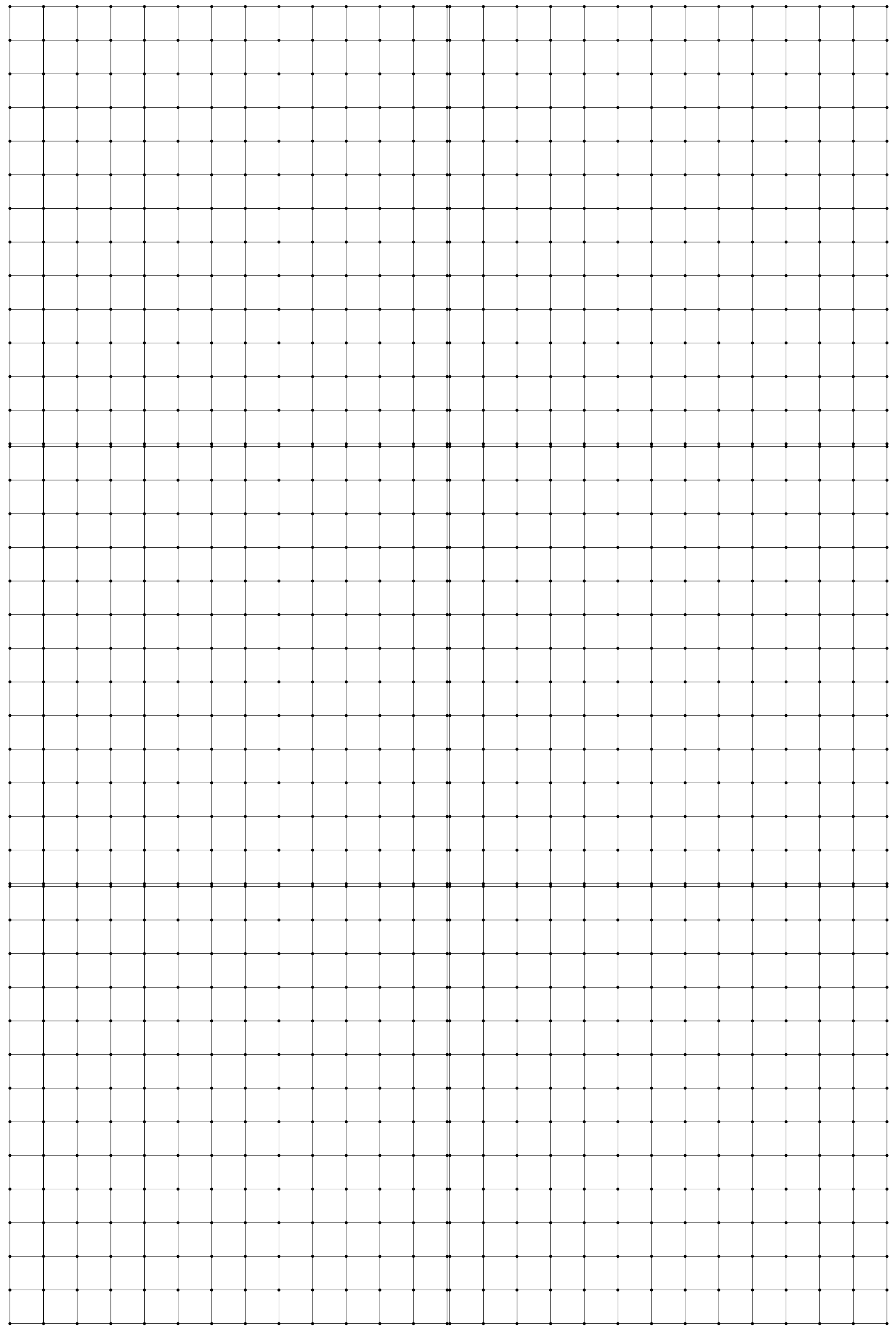

NOTES:



WHEN TO CONSULT A PROFESSIONAL

While this guide empowers you to measure accurately, certain situations may require professional assistance:

- **Irregular Layouts:** If your space includes curves, angles, or unique shapes, professional templates may be needed.
- **Full Kitchen Renovations:** For complex kitchen designs, expert help ensures no details are overlooked.

Contact our friendly customer support team if you get stuck or need some advice we can also video call to help you through the entire process.

Customer Support Team
+2761-153-9495
minimaalenmooi.com
minimaalenmooi@gmail.com

